

ThinCharge 7 Manual

ThinCharge Protective Battery Case

This ThinCharge battery case was designed to protect your iPhone while providing near double the battery power. This extra battery power allows you to do more of what you love and without worrying about your phone dying.

Installation & Removal

Installation

Carefully push back the top edge of the case and slide down iPhone from the top of the case.



Removal

Carefully push back the top edge of the case with two thumbs and push iPhone toward the top of the case.

*important: Push the iPhone from the bottom up to the top. Don't pull at an angle or you could damage the product.

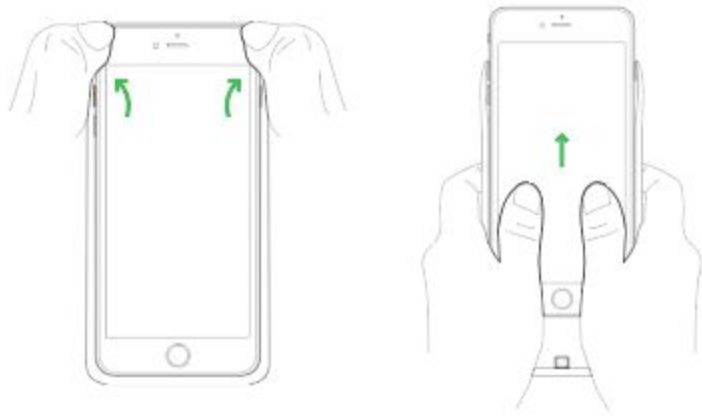

Charging

You can leave iPhone in the protective battery case to charge them both at the same time, or you can charge them separately.

1. Insert the Lightning to USB Cable that came with the iPhone into the Lightning connector at the bottom of the case. Use original adapter and cable for charging. The LED will always flash when charging.
2. Long press the switch at the bottom for about 2 seconds to start charging and stop charging. The LED will work for 30 seconds when the case is charging the iPhone.

*important: Use the original adapter and cable to charge or it may cause abnormal charge. Substandard voltage may cause abnormal charge.

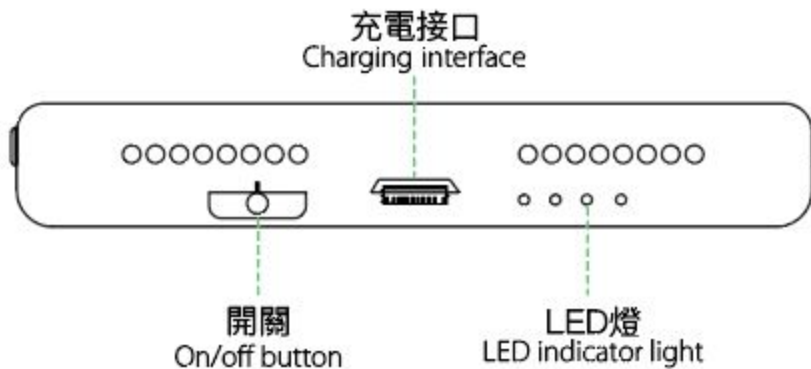

Power capacity and Indicator

1. Press the switch to check the power capacity.
2. The Power indicator will show four LED lights when it is fully charged to 100% battery.
3. One LED will indicate 25% power remaining.

Specifications

Input: DC 5.2V, 1.5 A max

Output: DC 5.0V, 1.0 A max

iPhone 7 Capacity: 2,700mAh 10.27 Wh

iPhone 7 Size: 143mm (~5.6in) x 71.5mm (~2.8in) x 12.5mm (~0.49in)

iPhone 7 Weight: 90g

iPhone 7+ Capacity: 3,600mAh 13.68 Wh

iPhone 7+ Size: 163mm (~6.5in) x 82mm (~3.2in) x 12.7mm (0.5in)

iPhone 7+ Weight: 115g

Minimum and Maximum operating temperatures: 0-35°C (32-95°F)



Safety Information

*Warning: Failure to follow these safety instructions could result in fire, electrical shock, or other injury or damage.

1. Don't open, remove, crush, or puncture the protective battery case. Any external force to the case can cause a circuit shortage.
2. Don't force, drop, or press the protective battery case.
3. When cleaning the Lightning connector, use a soft, dry, lint-free cloth. Don't use liquids or cleaning products.
4. Don't sit or sleep on the ThinCharge Battery Case.
5. Don't use it in a strong electrostatic or strong magnetic field. That will easily cause damage to the protective board.
6. Don't put the battery near a high temperature source such as fire, heat source, etc.
7. Do not use nails or other sharp objects to puncture the product.
8. If the battery case has an odor, is abnormally hot, has a deformation or other abnormal issues, remove the product or charger and stop using immediately.
9. If the product has a battery leakage which causes electrolytes to get into the eyes, do not rub. Rinse eyes immediately! Seek medical treatment to prevent damage to the eyes.
10. A long-term break not using the protective case is not recommended. Be sure to charge and discharge the case every 3 months if it's not in use.
11. Abandoned/unused batteries should follow the local laws and regulations and requirements for discarding.
12. Don't disassemble the battery for any reason.

Do not substantially or forcefully bend the case backward as it will cause breakage of the case.

※禁止把產品上半部分向後大幅度彎折，這樣會至使產品變形。

Prohibited upper part backward product substantially bent, otherwise it will make the product variants.

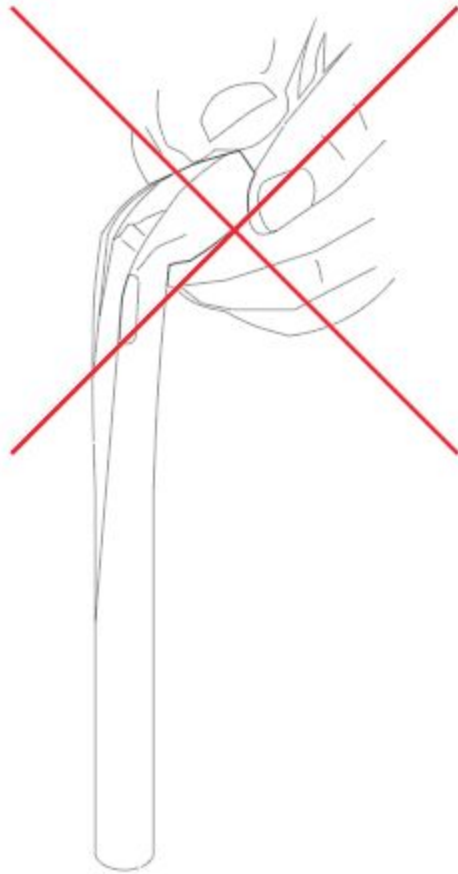

www.ChargeTech.com

© 2017 ChargeTech Enterprises, LLC. All Rights Reserved.